

HYDRAULIC COUPLERS



- ✓ Low-flow and high-flow couplers, from 6 to 40 litres/min.
- ✓ 700 and 1.000 bar couplers have 3/8"-18 NPTF thread.
- ✓ Male and female couplers can be supplied separately.
- ✓ Steel dust cup available for AZ3120, AZ3140 and AZ3141 couplers.
- ✓ AZ3321, AZ3325, AZ3341 and AZ3345:
ball quick couplers to guarantee easy and quick connection formerly used in cutters.
- ✓ AZ3120, AZ3140 and AZ3141: standard high-flow couplers.
- ✓ AZ3220 and AZ3240: low-flow couplers. Only used in legacy Maintenance Sets.
- ✓ All standard cylinders are supplied with AZ3140 female coupler.
- ✓ All cutters are supplied with AZ3140 female coupler.



WARNING

**Never disconnect the hose when the system is pressurized.
Never exceed the maximum working pressure of the hose.**



Apply 2 rounds of Teflon around all 3/8" NPTF threads of the system, in the thread direction, leaving the first thread uncovered to prevent the tape breaking and entering the hydraulic system. Torque: 80 Nm.



HYDRAULIC COUPLERS



Type **AZ3**

Capacity **6 - 40 l/min**

Max. pressure **700 - 1.000 bar**

Steel dust cap available:
AZ3144 for female couplers AZ3140 and AZ3141



Rubber dust cap AZ3145 available
to suit AZ3120, AZ3140 and AZ3141 couplers



AZ3321 and AZ3325 **male** couplers are connectable with AZ3341 and AZ3345 **female** couplers

HIGH-FLOW COUPLERS 700 BAR

AZ3120

AZ3140

AZ3141

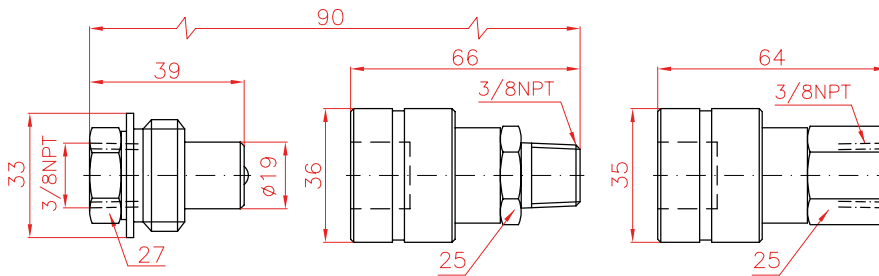

LOW-FLOW COUPLERS 700 BAR

AZ3220

AZ3240

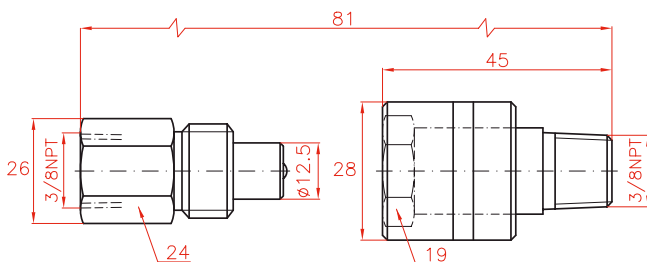

1.000 BAR BALL COUPLERS

AZ3321

AZ3341

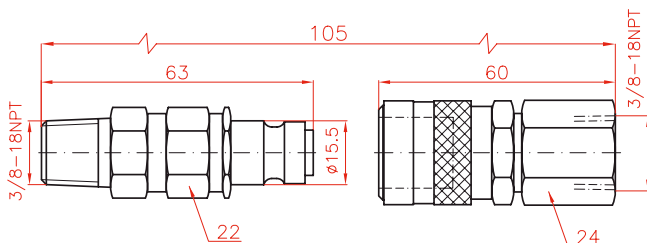

AZ3325

AZ3345

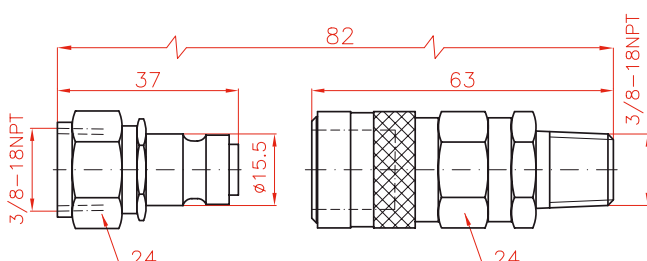

Flow l/min	Coupling	Model	Thread	Pressure
		LARZEP	NPTF	bar
40	Male	AZ3120	Female 3/8"	700
	Female	AZ3140	Male 3/8"	700
	Female	AZ3141	Female 3/8"	700
7	Male	AZ3220	Female 3/8"	700
	Female	AZ3240	Male 3/8"	700
6	Male	AZ3321	Male 3/8"	1.000
	Male	AZ3325	Female 3/8"	1.000
	Female	AZ3341	Female 3/8"	1.000
	Female	AZ3345	Male 3/8"	1.000